

SCALE- 40 perches to an inch.

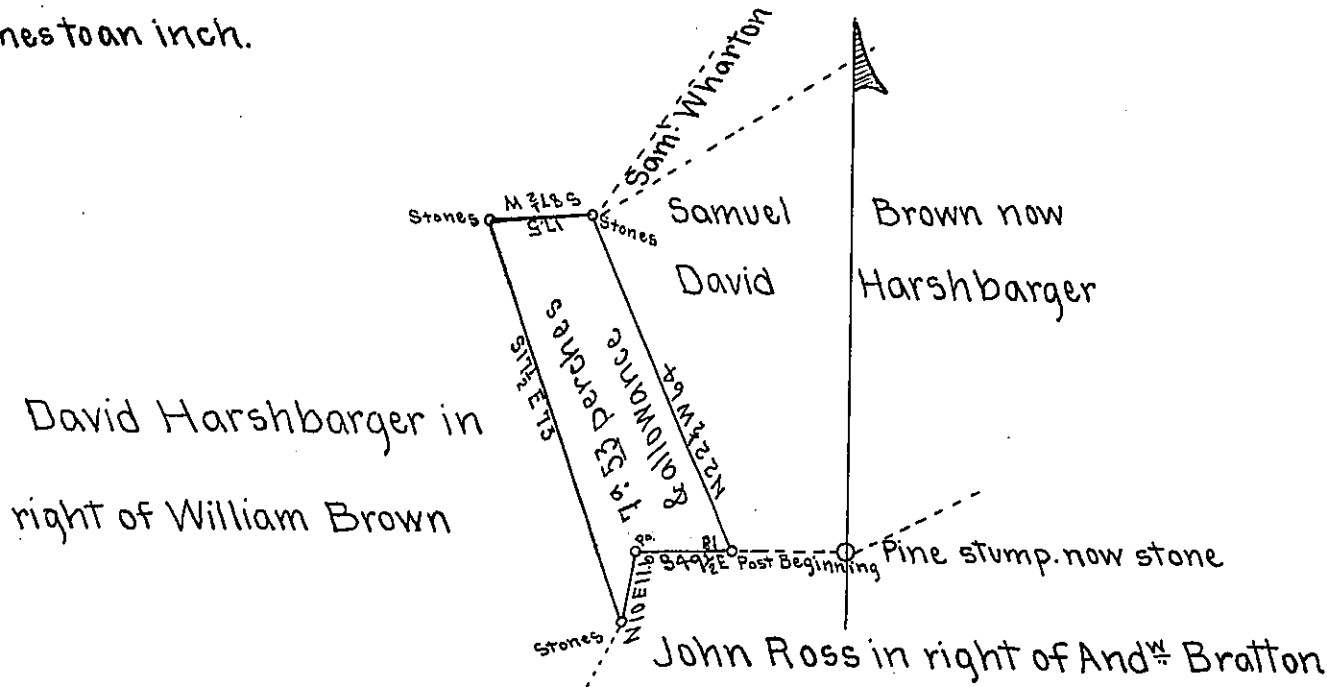

A Draught of 7⁵³ perches of land, with allowance of 6 per Cent for Roads &c. Situate in Bratton Township Mifflin County, surveyed in part Nov. 24th & finished December 16th 1863 in pursuance of a Warrant to David Harshbarger for 8th dated August 26th 1863. About 4^{ac} cleared and cultivated for a long time. A few apple trees on it which look to be forty years old or more.

To James P. Barr Esq }
 Surveyor General of Penn^a }

John R. Weekes C.S.

IN TESTIMONY that the above is a copy of the original remaining on file in the Department of Internal Affairs of Pennsylvania, made conformably to an Act of Assembly approved the 16th day of February, 1833, I have hereunto set my Hand and caused the Seal of said Department to be affixed at Harrisburg, this ixentieth day of March 1905

James P. Barr
 Secretary of Internal Affairs.